

USER MANUAL

Longitudinal label slitter



*Please keep the original packaging in case you need to return the unit.
If we receive the system in non-original packaging, the warranty may be void.*

HOW TO INSTALL THE CORE HOLDERS

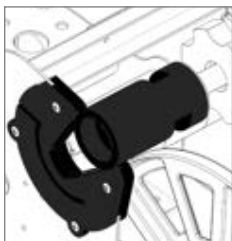
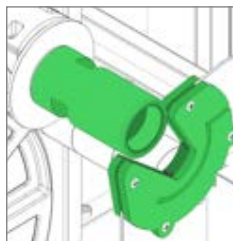

The green handle must match with the green holder and the black handle with the black holder.

IMPORTANT: screws must be face down.

HOW TO LOAD THE CORE HOLDERS

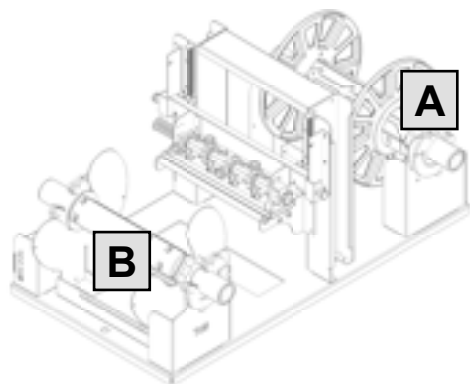

A > Unwinder core holder

B > Rewinder core holder

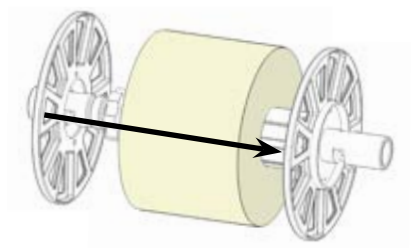

A - Unwinder core holder

Load the printed roll and move it against the disk.

Insert the outer disk and tighten the core holder.

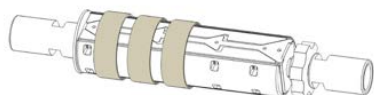

B - Rewinder core holder

Load empty cardboard core(s).

RUN A JOB

1

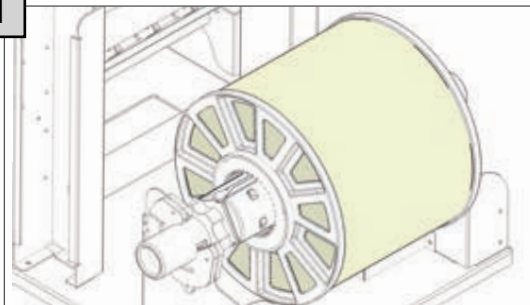

Insert the unwinder core holder onto its respective support.

2

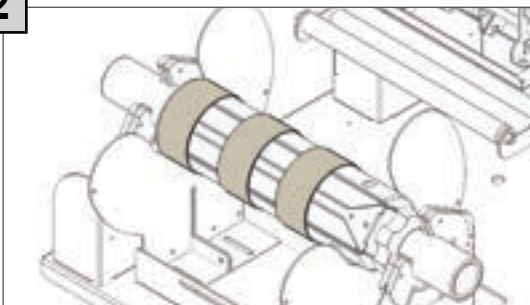

Insert the rewinder core holder onto its respective support.

3

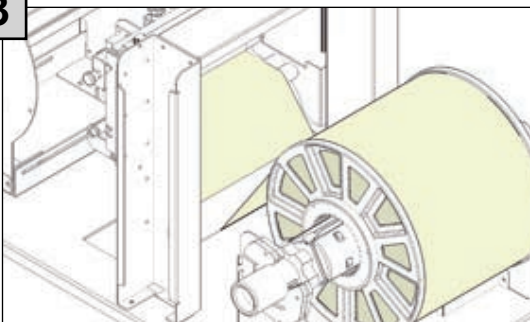

Guide the media under the first roller and use the picture below for the media path.

4

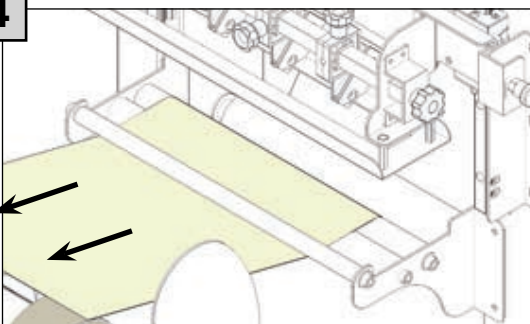

Pull the media for about fifty centimeters.

**!PLEASE PAY ATTENTION
TO THE PAPER PATH!**

Paper Path

—— Label face out
- - - Label face in

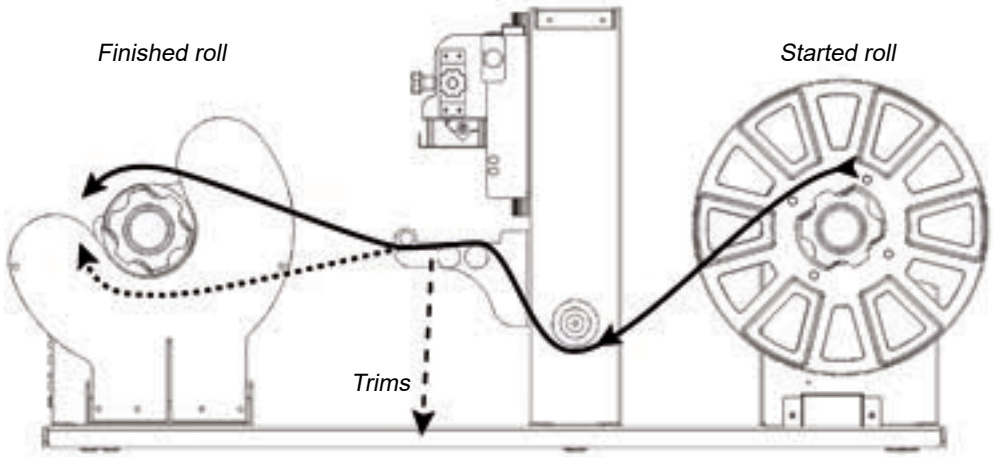

5

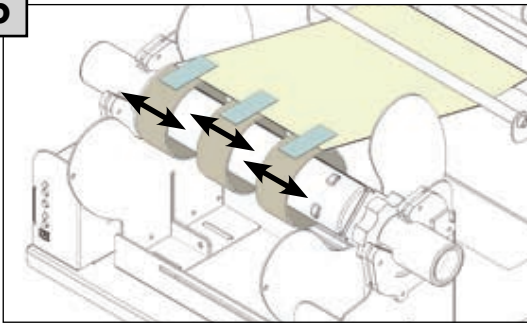

Temporarily attach the label directly to the take-up core holder.

This will provide the necessary tension in order to start the slitting process.

6

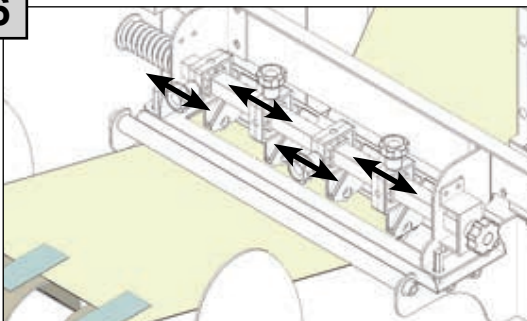

Position the blades in between each column and on either edge if desired.

You can alternate the position of the thumb screw from the top to the side to gain easier access.

WARNING!

The slitter blades are exposed and VERY sharp when the slitter station is in the "up" position. Use extreme caution!

SLITTER MODULE

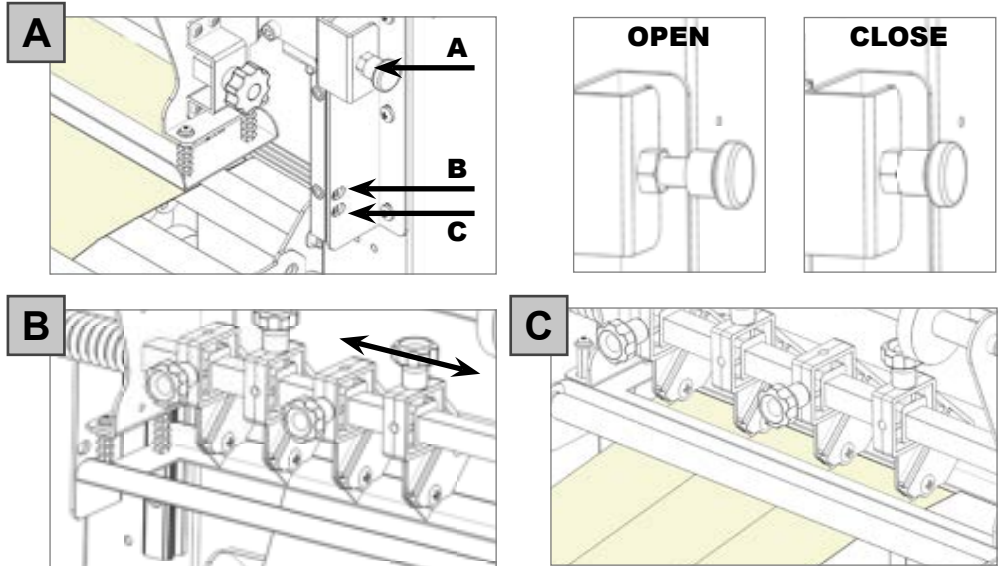

Slitter module has 3 positions:

- Upper position (A), the blades are lifted to allow the media loading;
- Middle position (B), align the blades with the edges and the center of the labels, tighten the thumb screw once the blade is in position;
- Lower position (C), the blade will penetrate and slit the media.

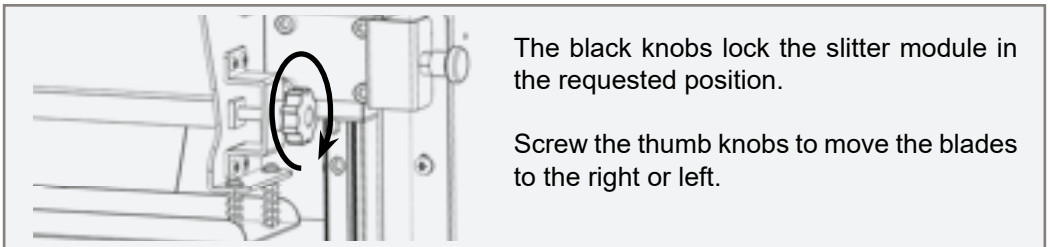

7

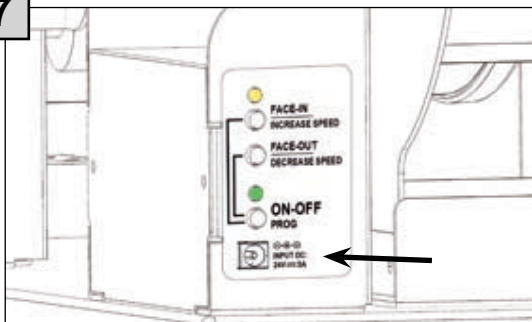

Plug the machine and switch it on.

The rewinder core holder will start to run.

8

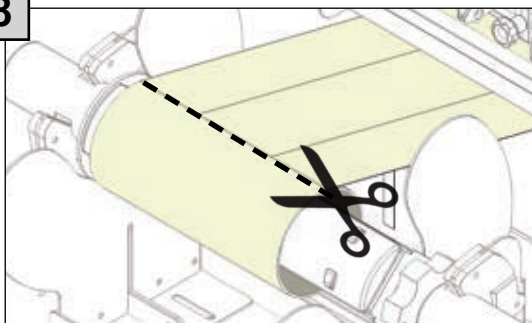

Cut the labels when you are satisfied with the results then turn off the unit.

9

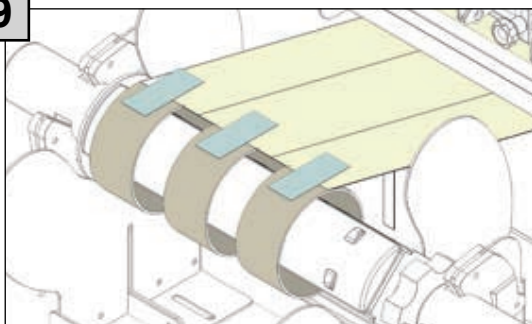

Make sure the tension on all rolls is even and attach each label to the core using a waste label.

10

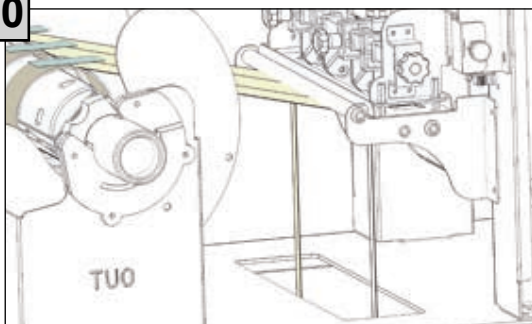

Allow the trimmed waste edges to fall into the waste basket under the hole.

**Note:**

*Make sure the media tension on all rolls is even.
If this does not happen, the entire slitting process could be compromised!*

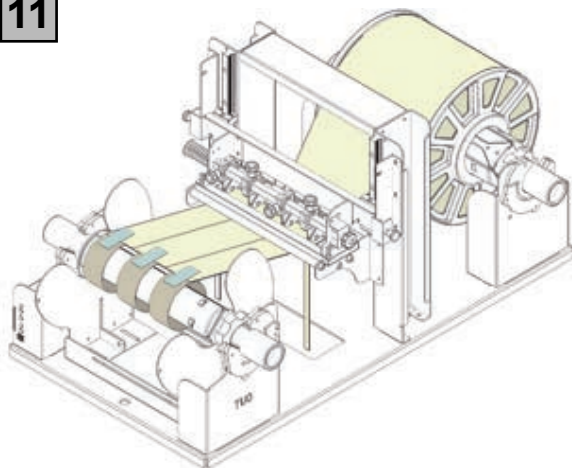
11

Turn the unit on and slowly increase the speed while observing the following areas for errors:

- 1. Slitting**
- 2. Finishing Core holder**

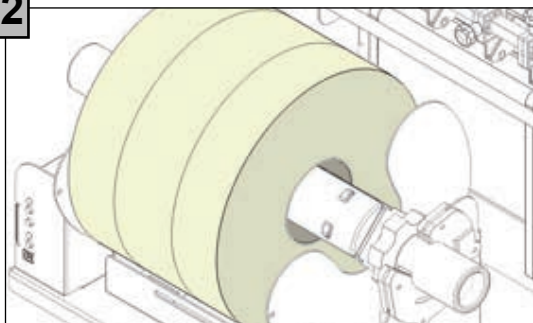
12

When the roll is finished, the unit automatically stops.

HOW TO REPLACE THE SLITTER BLADE

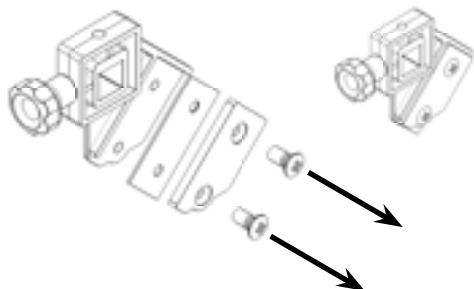

Loosen the two screws holding the blade in place.

Replace the blade.

Reassembly the blade holder by installing the screws.

HOW TO ADD OR REMOVE BLADE HOLDERS

1

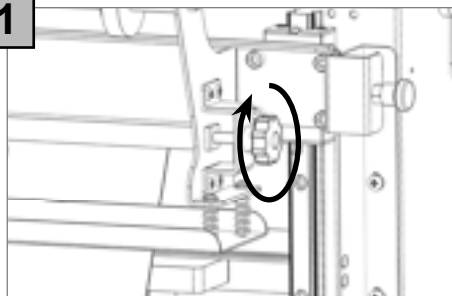

Remove the iron bar by unscrewing the black thumb screw.

2

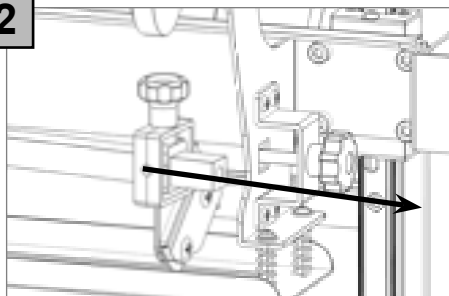

Insert or remove the blade holder(s) depending on the job.
Reinstall the slide iron bar and re-screw the thumb screw.

CONTROL PANEL



ON-OFF

Push this button to turn the unit On or Off.

INCREASE SPEED

Push this button to increase the rotation speed.

DECREASE SPEED

Push this button to decrease the rotation speed.

LABEL FACE-OUT

Turn the unit off. While holding the “FACE OUT” button press and release the “ON-OFF” button while the green led turns on and off. The unit is now ready to operate.

LABEL FACE-IN

Turn the unit off. While holding the “FACE IN” button press and release the “ON-OFF” button while the green led turns on and off. The unit is now ready to operate.